

Parts

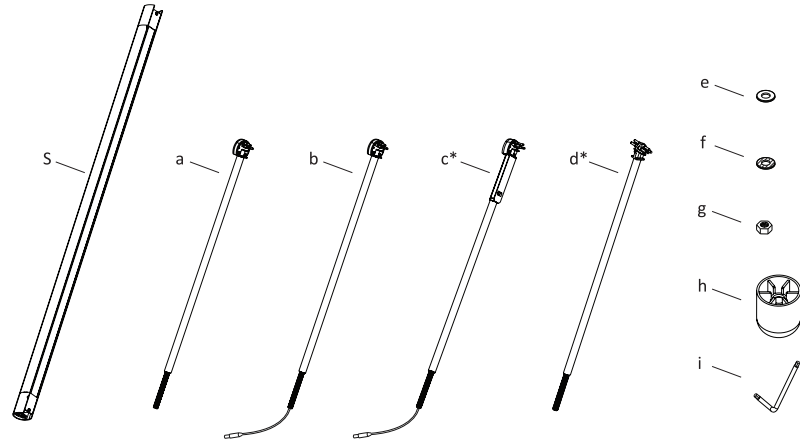

S. LED luminaire
a. End bar
b. End bar with cable
c. End bar with control unit*

d. Connecting bar*
e. Finished washer
f. Unfinished washer
g. Nut

h. Cap
i. Hex key**

*Optional

**After installation, store the hex key in a safe place. Sobre™ cannot be safely uninstalled without the hex key.

Assembly Instructions

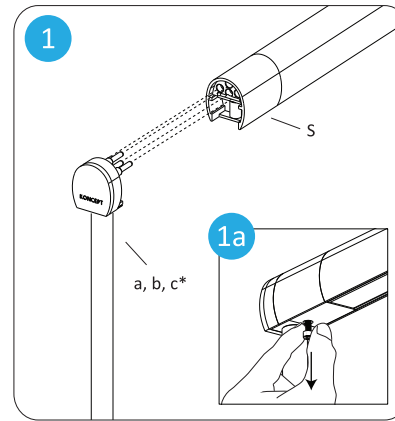

Push the end bars into the luminaire. If you experience difficulty pushing the bars into the luminaire, make sure the hex screw is disengaged. To disengage the hex screw, loosen up the screw using the provided hex key, and then pull down the screw (see 1a)

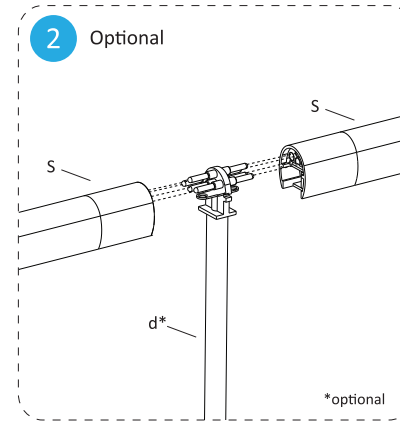

Push the connecting bar(s) into the luminaires to connect the modules. If you experience difficulty pushing the bars into the luminaire, make sure the hex screw is disengaged. To disengage the hex screw, loosen up the screw using the provided hex key, and then pull down the screw (see 1a)

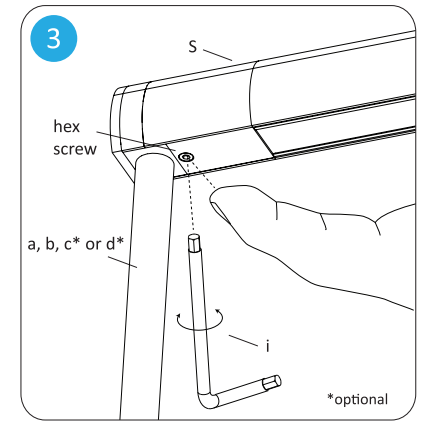

After the bars are fully inserted, push in the hex screw so it engages the end bars and the connecting bar(s). If the screw head shows above the surface, tighten the screw until it is flush with the surface using the provided hex key.

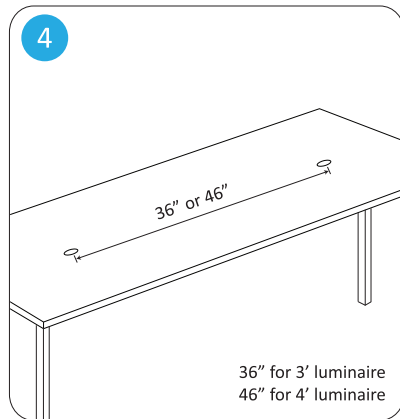

Drill two or more 7/16" diameter holes as needed in the table. Center the hole placement on the table, making sure the holes for the 3' luminaire are 36" apart, and holes for the 4' luminaire are 46" apart.

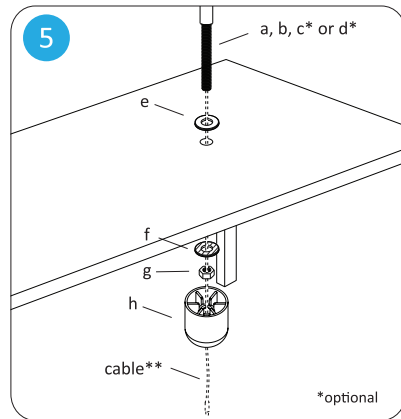

Fit the bars into the hole on the table. Use the provided washers as illustrated and fasten the nut to secure the bar. Use the cap to cover any part of the bar that is showing under the table.
**If the bars come with a cable, guide the cable through the hole, washer, nut and cap.

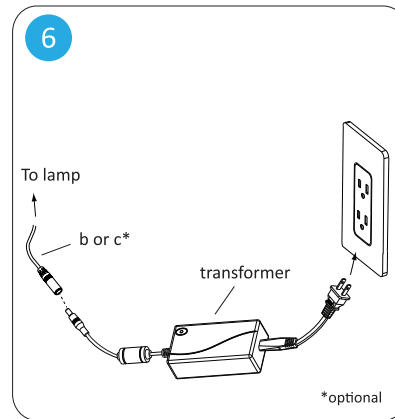

Connect the transformer to the lamp cable, then plug in the transformer to the wall outlet.

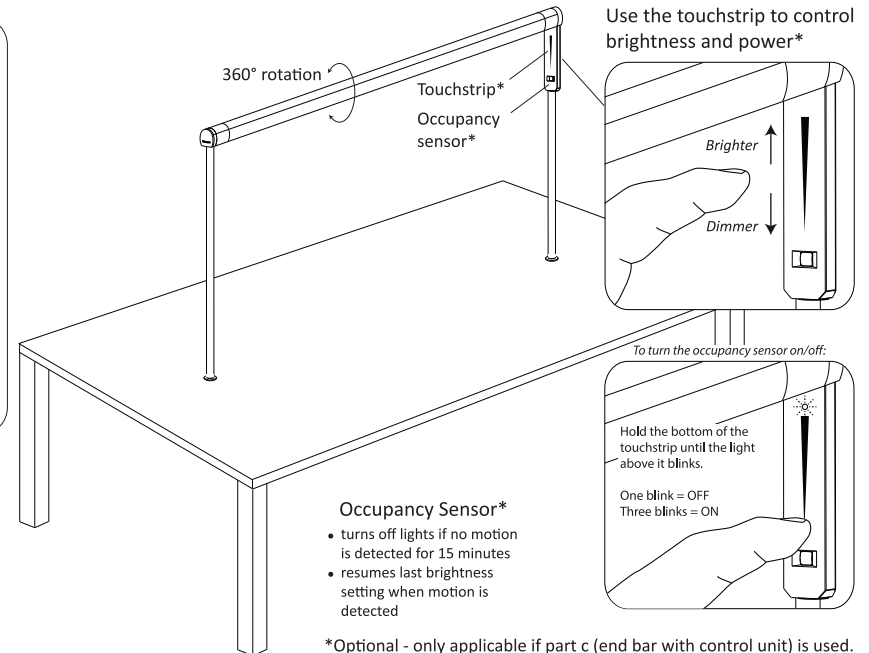

Parts

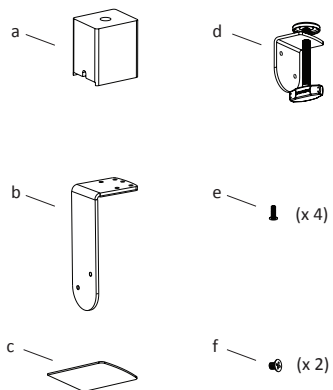

- a. Mounting block
- b. Clamp piece
- c. Black adhesive
- d. Screw handle
- e. Long screw (x 4)
- f. Short screw (x 2)

Assembly Instructions

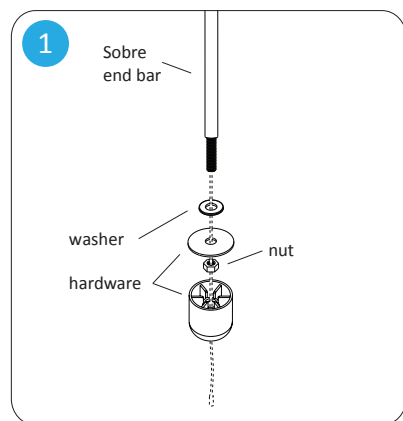

Remove the hardware from the Sobre end bar(s). Leave one washer for use in step 2.

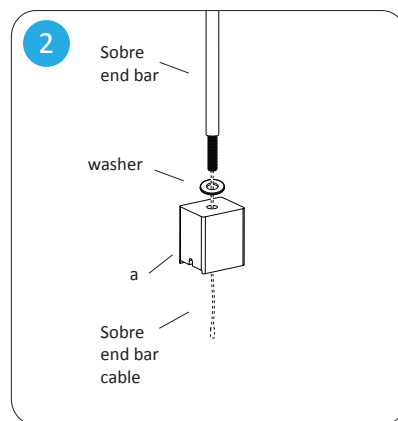

Insert the Sobre end bar into the hollow tube of the mounting block. If the end bar comes with a cable, feed the cable through the tube before inserting.

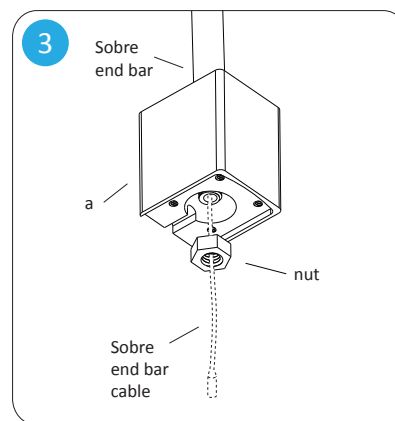

Secure the Sobre end bar to the mounting block with the nut retained from Step 1 using a pair of needle-nose pliers.

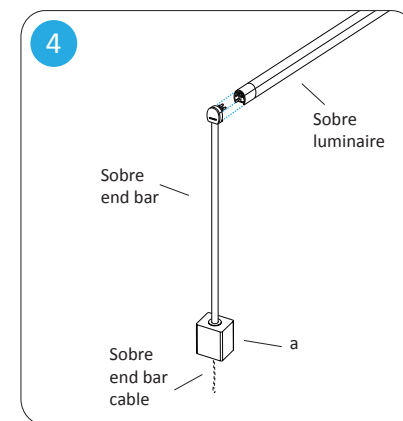

Make sure the plug of the Sobre end bar is facing inward and in the same direction as the wider side of the mounting block. Plug in luminaire to the end bar (refer to Sobre user manual for further lamp assembly instructions).

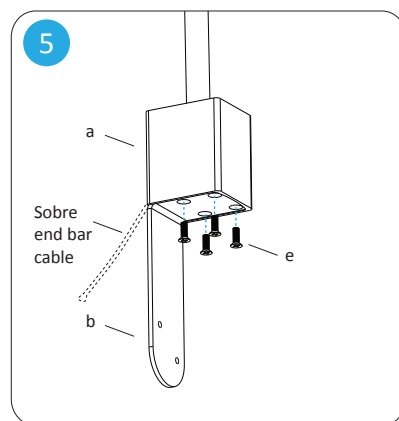

Attach the clamp piece to the mounting block using the long screws.

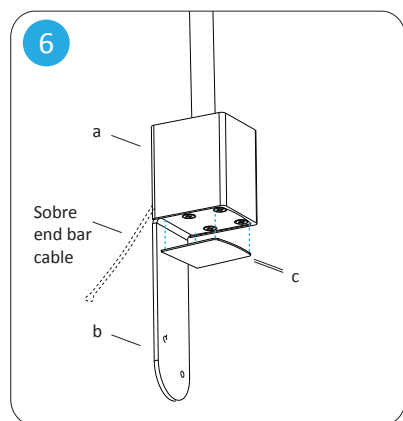

Attach the black adhesive to protect the screws.

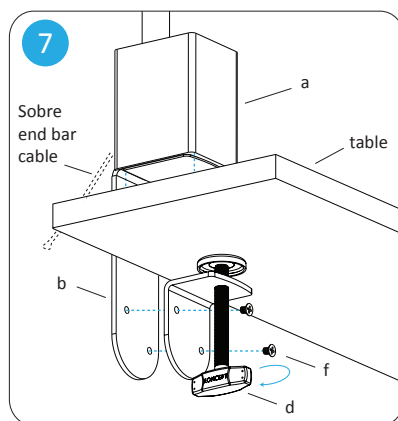

Sit the mount on the edge of the table. Attach the screw handle to the clamp piece with the short screws.

Fasten the screw handle to secure the mount to the table. Repeat Step 1 to 7 to other Sobre bars.

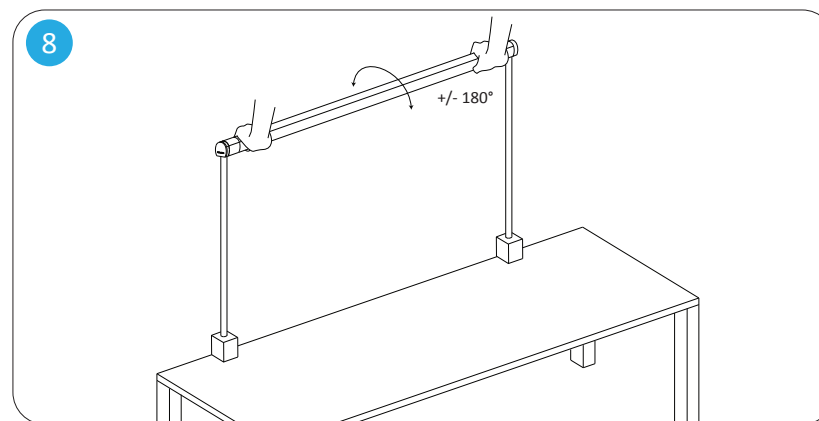

The luminaire can be turned 180 degrees each way to aim the light in the desired direction.